

INSTALLATION INSTRUCTIONS

DESCRIPTION: Side Case Stay
PART NUMBER: BW3-F84G0-V0
MODEL: '21+ Ténéré 700



⚠ WARNING

Please read and understand these instructions completely before installation to avoid possible injury, or damage to the accessory or vehicle.

NOTICE:

Installation of this kit requires a torque wrench and should be performed by an authorized Yamaha dealer or a qualified mechanic.

WARRANTY INFORMATION:

In the United States, see your Yamaha dealer for a copy of the Yamaha Genuine Parts and Accessories Limited Warranty.

DEALER OR INSTALLER:

These instructions contain important information for future reference and *must* be given to the customer.

PARTS LIST:

No.	Part Number	Description	Qty
--	BW3-F84G0-V0	Side Case Stay	--
①	-	Upper brace	1
②	-	Left Side Brace	1
③	-	Right Side Brace	1
④	-	M8X70mm Socket Head Bolt	4
⑤	-	M8 Washer	4
⑥	-	Spacer 36.5	2
⑦	-	M8x45mm Socket Head Bolt	4
⑧	-	Lower Brace	1
⑨	-	M8x16mm Flanged Hex Head Bolt	4
⑩	-	M8x100mm Socket Head Bolt	4

* Part supplied with kit only and not available separately.

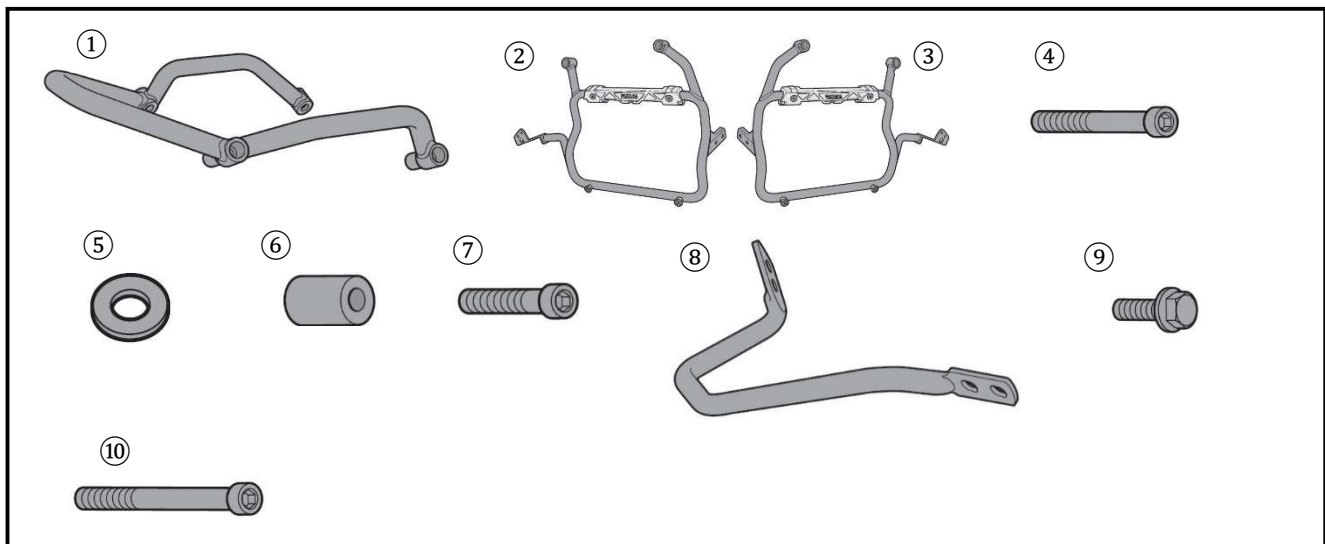

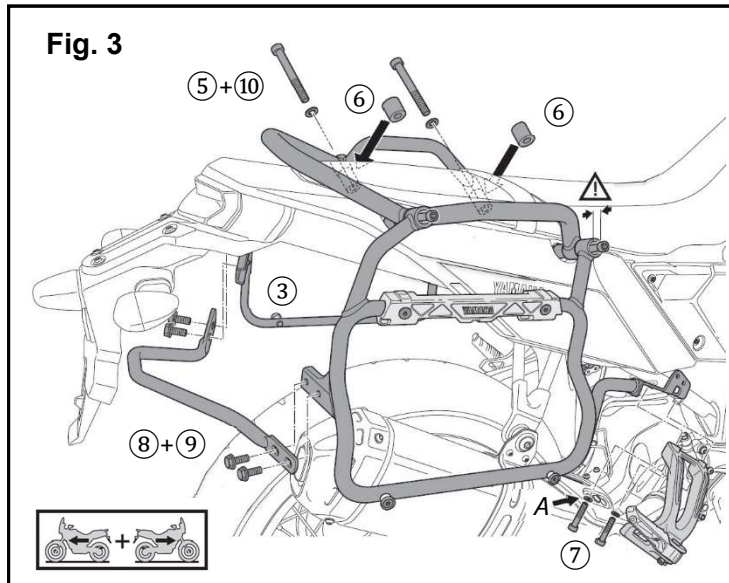
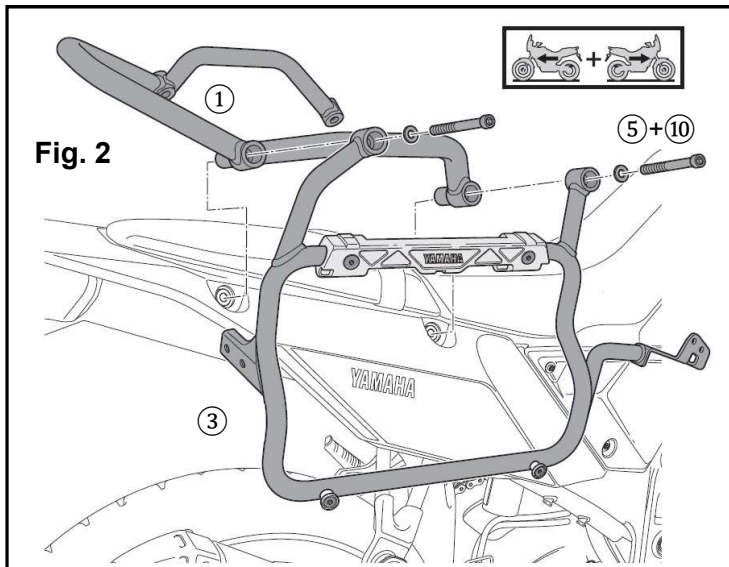
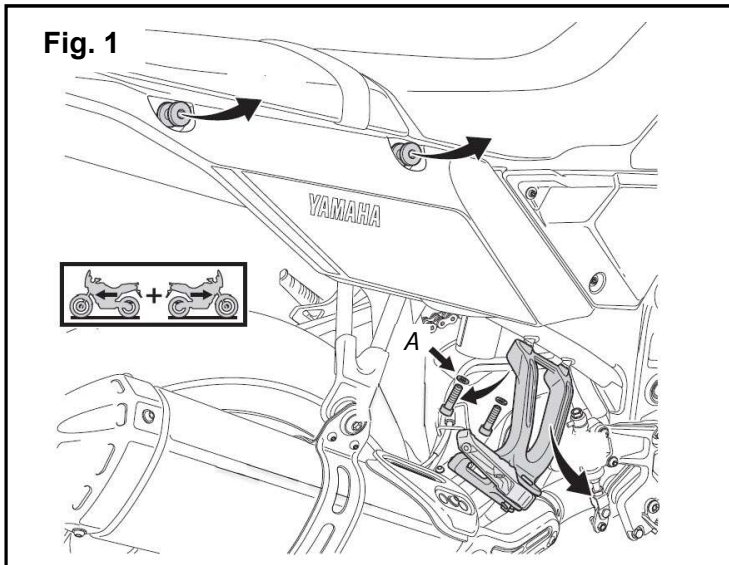

PREPARATION:

- Place the vehicle on a secure and level surface.
- Clean the mounting surfaces before beginning installation.

INSTALLATION:

1. Remove the stock passenger foot pegs and the tie down mounts in the tail section. The (A) washers will be reused. (Fig.1)
2. Place the (1) Upper Brace over the tail section and align the (3) Right Side Brace over the (1) Upper Brace and the passenger foot peg mounting locations. Thread in two (10) M8X100mm Socket Head Bolts with two (5) M8 Washers into the tail section. Leave loose for adjustments. (Fig. 2)
3. On the left side of the motorcycle, insert the (6) Spacers 36.5 under the (1) Upper Brace in the tail section mounting holes.
4. Align (2) Left Side Brace over the (1) Upper Brace mounting holes and the left side passenger foot peg location. Thread in two (10) M8X100mm Socket Head Bolts with two (5) M8 Washers into the tail section. Leave loose for adjustments. (Fig. 3)
5. Align the (8) Lower Brace over the mounting holes in both (2) and (3) Side Braces and thread in four (9) M8x16mm Flanged Hex Head Bolts.
6. Install both passenger foot pegs using the four (7) M8x45mm Socket Head Bolts with the stock washers (A). (Fig. 3)
7. Align the braces so they are straight on the motorcycle. Torque four (9) M8x16mm Flanged Hex Head Bolts to 10Nm (1.0 kg-m or 7.3 lb-ft) and the rest to 20 Nm (2.0 kg-m or 14.7 lb-ft).

Notice:

This kit is designed to work with the accessory Rear Carrier Kit (BW3-F48D0-V0). Remove the (1) Upper brace and replace it with the Rear Carrier Kit. The rest of the installation remains the same. There may be extra hardware that is not used.(Fig.4)

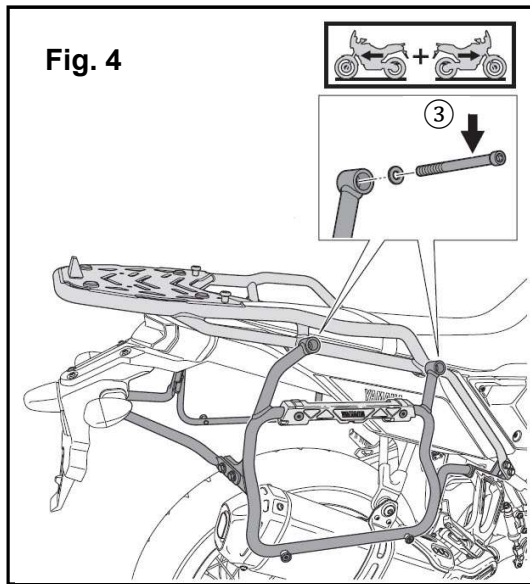

MAINTENANCE:

Periodically, check torque on all hardware. If loose hardware is found, re-torque to specification.

CARE AND CLEANING:

Clean painted metal parts with a clean soft cloth and mild soap and water solution. Rinse and dry.

CUSTOMER SERVICE:

For further information see your Yamaha dealer.

ESTIMATED TIME TO INSTALL: 0.5 HRS.